

## 4K UHD Mic Video Camera



(V2.0)

J. BC. 0205. 0143

## 4K UHD Mic Video Camera

---

### Product Advantages:

- Ultra-crystal video quality: adopts advanced DSP, 1/2.8 inch 8.42 megapixel sensor and high quality 12 megapixel lens.
- Support Auto Framing: Auto Framing participants at meeting start or enter, leave, or change positions.
- All video, control and power over single USB cable.
- Smart and solid design.
- Plug & play, avoid focal length setting.
- Flexible hinge design: fit for monitor, PC, tripod, wall mount and on desk mounting.
- USB2.0 YUY2/MJPEG/H.264 video format, works with Windows, MAC OS, Android, Linux.
- Standard UVC 1.1 protocol, compatible with most VC application.
- Built in dual microphone, pick up distance reach 5m.

### Product Features:

- USB2.0 super speed output.
- 12-megapixel fixed lens, 4x digital zoom.
- 120-degree field of viewing.
- Lens distortion rate less than 4% (120° FOV).
- 3840\*2160p30 ultra high resolution.
- Without motor inside, zero mechanical failure risk.
- Mirror, Flip, Anti-flicker feature.
- UVC control (via USB port).
- Audio communication protocol: UAC1.0.
- Audio encoding format: PMC.

## 4K UHD Mic Video Camera

### Model Spec

<b>Sensor</b>	1/2.8-inch high quality, 8.42-megapixel SONY CMOS sensor
<b>Video Format</b>	YUY2/NV12: 1280*720@15; 1024*576@20; 640*480@30
	MJPEG: 3840*2160@30; 2560*1440@30; 1920*1080@30; 1280*720@30; 1024*576@30; 640*480@30
	H.264/H.265: 3840*2160@30; 2560*1440@30; 1920*1080@30; 1280*720@30; 1024*576@30; 640*480@30
<b>Optical Zoom</b>	12-megapixel fixed lens
<b>Digital Zoom</b>	4X
<b>Field of Viewing</b>	120°
<b>Sensor Resolution</b>	8.42 megapixel
<b>Control Port</b>	USB2.0 (UVC/UAC)
<b>Video Port</b>	USB2.0
<b>S/N Ratio</b>	>50dB
<b>Focal Length</b>	f= 2.20mm
<b>Minimum Lux.</b>	0.1 lux
<b>White Balance</b>	Auto/Manual

## 4K UHD Mic Video Camera

<b>Iris</b>	F 2.2
<b>Electronic Shutter</b>	Auto
<b>Anti-Flicker</b>	50HZ/60HZ/OFF
<b>WDR</b>	Supported
<b>Polar distance</b>	3~5 meters
<b>Sensitivity</b>	-26±2dB RL=2.2KΩ Vs=2.0V
<b>Input Voltage</b>	4.4~5.25V@500mA (USB port)
<b>Dimension (L x W x H)</b>	199mm×92.5mm×65mm
<b>Net Weight</b>	0.32KG

### Explanation:

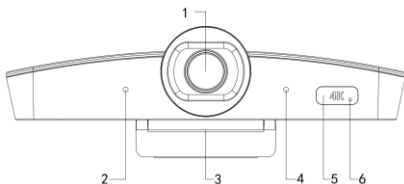

- |                 |                    |                    |
|-----------------|--------------------|--------------------|
| 1. Lens         | 2. Microphone 1    | 3. Base bracket    |
| 4. Microphone 2 | 5. Remote receiver | 6. Indicator light |

### Dimension Drawing: (mm)

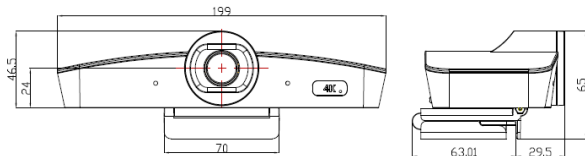

## 4K UHD Mic Video Camera

### IR REMOTE CONTROLLER:



**Power:** Standby/Start camera. (This button is temporarily disabled.)

**Image:** on/off.



**Preset:** long press for 3 seconds to save the current position to the corresponding preset, short press to run the preset, only available when Auto Framing is closed.

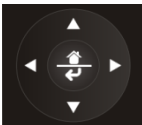

**Navigation keys:** up and down, left and right

In normal working mode, it is used to adjust the position of the electric pan tilt and to select menu items after entering the menu.



**Home/Confirm key:**

In normal working mode, a short press returns the electric pan tilt to the Home position, which is used to confirm the menu options after entering the menu.



**Auto:** Turn on Auto Framing.

**P/M(Push/Manual):** Close Auto Framing, and trigger Auto Framing once.



**Zoom keys:** +/-

Adjust the magnification of the electronic zoom, only available when Auto Framing is closed.

## 4K UHD Mic Video Camera

---

### OSD MENU:

SYSTEM	LANGUAGE	ENGLISH/CHINESE	
	PROTOCOL	Optional item: VISCA	Default: VISCA
	ADDRESS	VISCA:1~7	Default: 1
	BAUDRATE	2400,4800,9600,115200 optional	Default: 9600
	RETURN	Back to the main menu	

EXPOSURE	EXP.MODE	AUTO/MANU	Default: AUTO
	SHUTTER	Shutter speed:1/30~1/10000, only valid under MANU mode	Default: 1/100
	GAIN	Gain setting:0~15, only valid under MANU mode	Default: 0
	FLICK	OFF/50HZ/60HZ	Default: 50HZ
	BACKLIGHT	ON/OFF	Default: OFF
	GAMMA	0~15	Default: 8
RETURN	Back to the main menu		

IMAGE	WB MODE	AUTO/MANU	Default: AUTO
	B_GAIN	Blue gain level:0~256, only valid under manual	Default: 100
	R_GAIN	Red gain level:0~256, only valid under manual	Default: 100
	DEFOG	Set the image permeability: OFF/1~15	Default: OFF
	RETURN	Back to the main menu	

QUALITY	2D NR	Set 2D noise reduction level: ON/OFF	Default: OFF
	3D NR	Set 3D noise reduction level: OFF/AUTO/1~4	Default: AUTO
	SHARPNESS	Sharpness setting:0~15	Default: 8
	CONTRAST	Contrast setting:0~15	Default: 8
	SATURATION	Saturation setting:0~15	Default: 8
	BRIGHT	Bright setting:0~15	Default: 8
RETURN	Back to the main menu		

CTRL	MIRROR	Turn the screen left and right ON/OFF	Default: OFF
	FLIP	Picture up and down (hoisting mode)	Default: OFF
	AUTO FRAME	AUTO/MANU	Default: AUTO
	RETURN	Back to the main menu	

RESET	CAM RESET	Reset camera parameter to default	
	RETURN	Back to the main menu	

INFO	CTRL VER	Camera movement control program version	
	CTRL DATE	Release date of camera movement control program	
	RETURN	Back to the main menu	

## 4K UHD Mic Video Camera

---

### Suggested Installation Modes:



Model 1: on top of laptop



Model 2: on top of monitor



Model 3: on top of flat TV screen



Model 4: at the bottom of TV



Model 5: wall mount